

Evaporator

- Ideal for Distill of (Mixed) Solvent, Condensation Solution and Suspension, Concentrate Liquid, Re-crystallization, Dry Powder and Granulate, Synthesize Chemical, Soxhlet Extraction, Recycle Solvent.
- Water Bath Electric Lift, Easy to Use.
- PTFE and Fluorine Rubber Dual Rotating Seal, Patented Technology to Ensure High Vacuum.
- A Vacuum Switching Valve, without Affecting the System Vacuum Distillation of the Situation and the Solution can be Continuously Collected.

| | |
|--|-------|
| ● 0.5~3 Lit. Digital Rotary Evaporator | P. 47 |
| ● 10 & 20 Lit. Digital Rotary Evaporator | P. 48 |
| ● 50 Lit. Digital Rotary Evaporator | P. 49 |
| ● Electric Circulation Aspirator Pump | P. 50 |



Rotary Evaporator

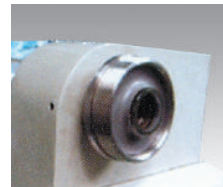

■ Rotary Shaft Seal



■ Operation Panel

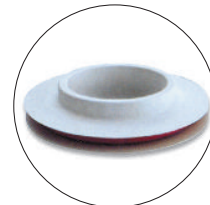

Flange Seal



PTFE Seals (Deputy)

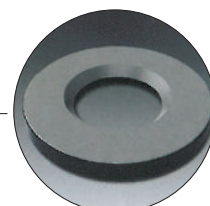

PTFE Seals (Main)

Patent No. 2010205147495

witeg® 0.5~3Lit. Digital Rotary Evaporator, "WEV-1001V", "WEV-1001L" Vertical & Diagonal Type

7.4 Lit. Digital Bath, 100°C, with PID Control & Lifting Table, 10~180rpm, 20ml/min, Cooling Surface 1.300cm²

- Ideal for Distill of (Mixed) Solvent, Condensation Solution and Suspension, Concentrate Liquid, Re-crystallization, Dry Powder and Granulate, Synthesize Chemical, Soxhlet Extraction, Recycle Solve
- Cooling Surface 1.300cm²
- Included 2xRotary Bottles: 1x0.5 Lit. & 1x1Lit.
- The Temperature adopts PID Control, which ensures accurate Temperature Control.
- Speed Display ,Operate Visually and easily

- * Digital Speed Display, Digital Temp. Display on Water Bath.
- * Double Sealing with PTFE and Fluorous Rubber to ensure High Vacuum Degree.
- * The Air Extraction Nozzle of Condenser is set down, and it is Safer after Connection with Vacuum Pipe
- * Building Block Design is Easily to be Extended.
- * Easy Operation of Lifting, Move up and Down Smoothly and Easy to Lock.
- * Dedicated Electric Machinery, Worm and Gear Drive Steadily.
- * The Separation of Bath and the Mainframe makes Configure Flexible.
- * These Rotary Evaporators could Set with Circulation Aspirator Pump(P.51) and Refrigerated Bath Circulators(P.30 ~ P.31).

Specification

| Spec. | Model | "WEV-1001V" | "WEV-1001L" |
|-----------------------------|-------|---|-----------------------------|
| Condenser Type | | Vertical-type | Diagonal-type |
| Bottle Capacity | | Rotary Bottle : 0.5/1/2 Lit., Receiving Bottle : 1 Lit. | |
| Rotary Speed | | 10 ~ 180 rpm | |
| Evaporating Capability | | 20 ml/min | |
| Achievable Vacuum | | 399.9Pa(below 3mmHg) | |
| Bath Capacity | | 7.4 Lit. / Ø260 x 140 mm | |
| Temp. Range | | 0°C ~ 99°C | |
| Functional of Lifting Table | | Weight Balancing Gliding Elevating & Manual Lifting | |
| Elevating Stroke | | 100 ~ 250 mm | |
| Vacuum Sealing | | Double Sealing Rings made of PTFE+Viton Materials | |
| Power Consumption | | Motor : 25 W, Heater : 1.5KW | |
| Controller & Display | | PID Controller, Digital display | |
| Dimension & Net Weight | | 560 x 320 x h660mm / 9.5 kg | 750 x 320 x h540mm / 9.5 kg |
| Power Supply & Cord Plug | | 220V, 60Hz | |

Ordering Information

- DH.WEV01001V (1) Digital Rotary Evaporator, Vertical-type, "WEV-1001V", 220V
 DH.WEV01001L (2) , Diagonal-type, "WEV-1001L", 220V



2-Year Warranty

(1) Digital Rotary Evaporator, Vertical-type "WEV-1001V", 0.5 ~ 3 Lit.



2-Year Warranty

(2) Digital Rotary Evaporator, Diagonal-type "WEV-1001L", 0.5 ~ 3 Lit.

Spare Parts details for "WEV-10001V" and "WEV-1001L" models

| No. | Order Number | Description |
|-----|-----------------|--|
| 1 | SL_Ev1001.A01 | Glass Feeding Valve |
| 2 | SL_Ev1001V.A02 | Glass Condenser, Ø85x390mm |
| 2-1 | SL_Ev1001L.A02 | Glass Condenser, Ø85x385mm |
| 3 | SL_Ev1001.A03 | Clamp for Receiving Bottle, SUS304, 90x33x50mm |
| 4 | SL_Ev1001.A04 | Glass Receiving Bottle, 1Lit. |
| 5 | SL_Ev1001.A05 | Condenser Locknut, PP, Ø75x23mm |
| 6 | SL_Ev1001.A06 | Circlip, SUS304, Ø38mm |
| 7 | SL_Ev1001.A07 | Deputy Vacuum Seal, PTFE, Ø51x5mm |
| 8 | SL_Ev1001.A08 | Main Vacuum Seal, PTFE, Ø51x5mm |
| 9 | SL_Ev1001.A09 | Bearing end Cap, PA, Ø83x28mm |
| 10 | SL_Ev1001.A10 | Rotary Axis, SUS304, Ø38x67mm |
| 11 | SL_Ev1001.A11 | O-ring, Silicon, Ø20x3mm |
| 12 | SL_Ev1001.A12 | Glass Rotation Axis, Ø22x190mm |
| 13 | SL_Ev1001.A13 | Auxiliary Bottle Opener, PC, Ø41x53mm |
| 14 | SL_Ev1001.A14 | Main Bottle Opener, PC, Ø41x53mm |
| 15 | SL_Ev1001.A15.1 | Glass Rotary Bottle, 500ml |
| 15 | SL_Ev1001.A15.2 | Glass Rotary Bottle, 1000ml |
| 15 | SL_Ev1001.A15.3 | Glass Rotary Bottle, 2000ml |
| 16 | SL_Ev1001.A16 | Motor Shroud, ABS, 145x100x180mm |
| 17 | SL_Ev1001.A17 | Lifting Column, Aluminum, 38x30x230mm |
| 18 | SL_Ev1001.A18 | Lifting Handle, PP, Ø24x115mm |
| 19 | SL_Ev1001.A19 | Base Plate, Aluminum, 320x460x20mm |
| 20 | SL_Ev1001V.A20 | Glass Condenser Bracket, SUS304, Ø10x280mm |

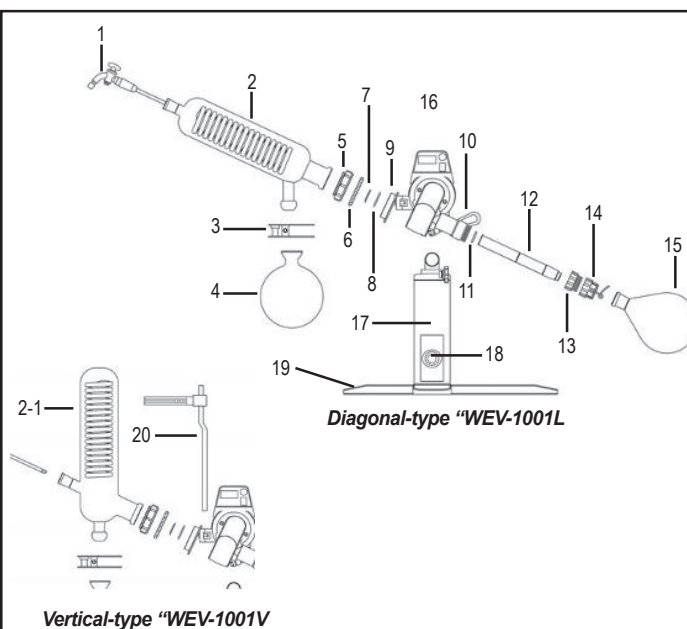

Vertical-type "WEV-1001V"

Diagonal-type "WEV-1001L"

witeg® 10 & 20 Lit. Digital Rotary Evaporator, "WEV-1010", "WEV-1020" Large Capacity, Vertical Type

Digital Controlled Stainless Steel Bath 99°C, 10~130 rpm, 6.5/11 Lit/h, Cooling Surface 6.500/11.500cm² with Certificate & Traceability

NEW

Wisdom
2-Year Warranty



Digital Rotary Evaporator, Large Capa.
"WEV-1010" 5 Lit., "WEV-1020" 10 Lit.

- Ideal for Distill of (Mixed) Solvent, Condensation Solution and Suspension, Concentrate Liquid, Re-crystallization, Dry Powder and Granulate, Synthesize Chemical, Soxhlet Extraction, Recycle Solve
- Cooling Surface: WEV-1010 total 6.500cm² | WEV-1020 total 11.500cm²
- PTFE and Fluorine Rubber Dual Rotating Seal, Patented Technology to ensure High Vacuum.
- A Vacuum Switching Valve, without Affecting the System Vacuum Distillation of the Situation and the Solution can be Continuously Collected.
- Stainless Steel Water Bath Electric Lift, Easy to Use.

- * Water Bath Electric Lift, Easy to Use.
- * The Introduction of Advanced Frequency Control System, Temperature Control System, Accurate and Reliable.
- * a Vacuum Switching Valve, without Affecting the System Vacuum Distillation of the Situation and the Solution can be Continuously Collected.
- * PTFE Discharge Valve, Corrosion Resistance, Pollution-free.
- * These Rotary Evaporators could Set with Circulation Aspirator Pump(P.51) and Refrigerated Bath Circulators(P.30 ~ P.31).

| Spec. / Model | WEV-1010 | WEV-1020 |
|-------------------------------------|---|---|
| Rotary Bottle | 10 Litre, Flange Opening Ø95mm | 20 Litre, Flange Opening Ø95mm |
| Receiving Bottle | 5 Litre | 10 Litre |
| Condenser | Standing, Main & Auxiliary Cooling and Highly Efficient 3 Circulating Cold Trap | |
| Temp. Range | 0°C - 99°C | |
| Rotary Speed | 10 - 130rpm | |
| Evaporating Capability | Water: 3.2Lit/h Alcohol: 6.5Lit/h | Water: 5Lit/h Alcohol: 11Lit/h |
| Cooling Surface | Main Condenser 4.500cm ² Auxiliary Condenser 2.000cm ² | Main Condenser 8.000cm ² Auxiliary Condenser 3.500cm ² |
| Achievable Vacuum | 399.9Pa (below 3mmHg) | |
| Functional of Lifting Table | Electric | |
| Elevating Stroke | 0 - 160mm | 0 - 190mm |
| Vacuum Sealing | PTFE and Fluorine Rubber Dual Rotating Seal | |
| Motor | Phase AD Induction Motor | |
| | 90 W | 180 W |
| Heating Boiler | Stainless Steel Water Bath | |
| Display | Digital Display | |
| Power Consumption | 4.8 kW | 6.3 kW |
| Dimension (mm) | 920 x 550 x h1700 | 1250 x 600 x h2100 |
| Power Supply & Cord Plug | 220V, 50Hz | 380V, 50 Hz |

Ordering Information

DH.WEV1010 Digital Rotary Evaporator, Large Capa., "WEV-1010", 10Lit., 220V
DH.WEV1020 "WEV-1020", 20Lit., 380V

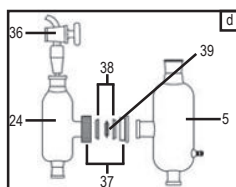
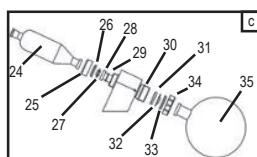
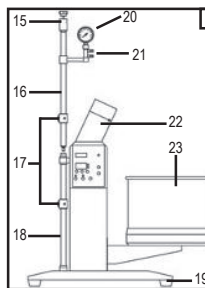
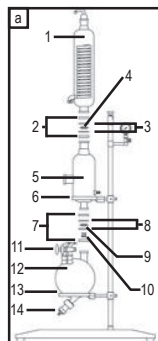
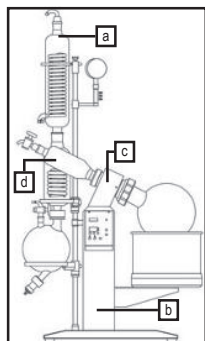

| No. | Order Number | Description | No. | Order Number | Description |
|-----|---------------|---|-----|---------------|---|
| 1 | SL.Ev1010.A01 | Glass Condenser(Main), Ø120x575mm, for "WEV-1010" | 19 | SL.Ev1010.A19 | Stand Base, Carbon Steel, 680x337mm, for "WEV-1010" |
| 1 | SL.Ev1020.A01 | Glass Condenser(Main), Ø135x738mm, for "WEV-1020" | 19 | SL.Ev1020.A19 | Stand Base, Carbon Steel, 451x850mm, for "WEV-1020" |
| 2 | SL.Ev1010.A02 | Connection Flange Set, Aluminum, Ø82x10mm, for "WEV-1010" | 20 | SL.Ev1010.A20 | Vacuum Gauge, Ø100mm, for "WEV-1010" & "WEV-1020" & "WEV-1050" |
| 2 | SL.Ev1020.A02 | Connection Flange Set, Aluminum, Ø110x15mm, for "WEV-1020" | 21 | SL.Ev1010.A21 | Vacuum Gauge Holder, Copper, 137x120x35mm, for "WEV-1010", "WEV-1020" |
| 3 | SL.Ev1010.A01 | Flange Retaining Ring, EPDM, Ø60x6mm, for "WEV-1010" | 22 | SL.Ev1010.A22 | Machine Head Capsule, Aluminum, 130x214x100mm, for "WEV-1010" |
| 3 | SL.Ev1020.A03 | Flange Retaining Ring, EPDM, Ø86.5x10mm, for "WEV-1020" | 22 | SL.Ev1020.A22 | Machine Head Capsule, Aluminum, 290x137x50mm, for "WEV-1020" |
| 4 | SL.Ev1010.A04 | Flange Gasket, PTFE, Ø45x12mm, for "WEV-1010" | 23 | SL.Ev1010.A23 | Water Bath, SUS304, Ø345x215mm, for "WEV-1010" |
| 4 | SL.Ev1020.A04 | Flange Gasket, PTFE, Ø75x12.5mm, for "WEV-1020" | 23 | SL.Ev1020.A23 | Water Bath, SUS304, Ø450x255mm, for "WEV-1020" |
| 5 | SL.Ev1010.A05 | Auxiliary Glass Condenser, Ø134x400mm, for "WEV-1010" | 24 | SL.Ev1010.A24 | 3-way Glass Bottles, Ø100x338mm, for "WEV-1010" & "WEV-1020" |
| 5 | SL.Ev1020.A05 | Auxiliary Glass Condenser, Ø165x575mm, for "WEV-1020" | 25 | SL.Ev1010.A25 | Fixed Nut, for 3-way Glass Bottles, Aluminum, Ø90x29mm, for "WEV-1010", "WEV-1020" |
| 6 | SL.Ev1010.A06 | Auxiliary Glass Condenser Tray, EPDM, Ø116mm, for "WEV-1010" | 26 | SL.Ev1010.A26 | Fixed Nut Retainer Ring, 3-way Glass Bottles, PA , Ø65x10mm, for "WEV-1010", "WEV-1020" |
| 6 | SL.Ev1020.A06 | Auxiliary Glass Condenser Tray, EPDM, Ø150mm, for "WEV-1020" | 27 | SL.Ev1010.A27 | Flange Seals, PTFE, Ø55x12.5mm, for "WEV-1010", "WEV-1020" |
| 7 | SL.Ev1010.A07 | Connection Flange Set, Aluminum, Ø82x10mm, for "WEV-1010", "WEV-1020" | 28 | SL.Ev1010.A28 | Rotation Glass Axis, Ø60x185mm, for "WEV-1010" |
| 8 | SL.Ev1010.A08 | Flange Retaining Ring, EPDM, Ø60x6mm, for "WEV-1010", "WEV-1020" | 28 | SL.Ev1020.A28 | Rotation Glass Axis, Ø60x195mm, for "WEV-1010", "WEV-1020" |
| 9 | SL.Ev1010.A09 | Flange Gasket, PTFE, Ø45x12mm, for "WEV-1010", "WEV-1020" | 29 | SL.Ev1010.A29 | O-ring, EPDM, Ø38x3.1mm, for "WEV-1010", "WEV-1020" |
| 10 | SL.Ev1010.A10 | Automatic Switching Valve, Ø31x23mm, for "WEV-1010", "WEV-1020" | 30 | SL.Ev1010.A30 | Couplings, SUS304, Ø116x45mm, for "WEV-1010", "WEV-1020" |
| 11 | SL.Ev1010.A11 | Glass Bleed Valve, for "WEV-1010", "WEV-1020" | 31 | SL.Ev1010.A31 | Main Vacuum Seal, PTFE, Ø96x10mm, for "WEV-1010", "WEV-1020" |
| 11 | SL.Ev1020.A11 | Glass Bleed Valve, for "WEV-1010", "WEV-1020" | 32 | SL.Ev1010.A32 | Deputy Vacuum Seal, PTFE, Ø96x10mm, for "WEV-1010", "WEV-1020" |
| 12 | SL.Ev1010.A12 | Glass Receiving Bottle, 5Lit., for "WEV-1010" | 33 | SL.Ev1010.A33 | Retaining Ring, PA, Ø107x15mm, for "WEV-1010", "WEV-1020" |
| 12 | SL.Ev1020.A12 | Glass Receiving Bottle, 10Lit., for "WEV-1020" | 34 | SL.Ev1010.A34 | Rotating Shaft Nut, PA, Ø78x29mm, for "WEV-1010", "WEV-1020" |
| 13 | SL.Ev1010.A13 | Glass Receiving Bottle Tray, Ø227mm, for "WEV-1010", "WEV-1020" | 35 | SL.Ev1010.A35 | Glass Rotary Bottle, 10Lit., for "WEV-1010" |
| 14 | SL.Ev1010.A14 | Discharge Valve, PTFE, Ø56x120mm, for "WEV-1010" | 35 | SL.Ev1020.A35 | Glass Rotary Bottle, 20Lit., for "WEV-1020" |
| 14 | SL.Ev1020.A14 | Discharge Valve, PTFE, Ø56x120mm, for "WEV-1020" | 36 | SL.Ev1005.A36 | Glass Feeding Valve, for "WEV-1010", "WEV-1020" |
| 15 | SL.Ev1010.A15 | Condenser Clamp, SUS304, 113-140, for "WEV-1010", "WEV-1020" | 37 | SL.Ev1010.A37 | Connection Flange Set, Ø90x12mm, for "WEV-1010", "WEV-1020" |
| 16 | SL.Ev1010.A16 | Stand Pole, SUS304, Ø25x697mm, for "WEV-1010", "WEV-1020" | 38 | SL.Ev1010.A38 | Flange Retaining Ring, EPDM, Ø70x10mm, for "WEV-1010", "WEV-1020" |
| 17 | SL.Ev1010.A17 | Stand Folder, SUS304, Ø25x12mm, for "WEV-1010", "WEV-1020" | 39 | SL.Ev1010.A39 | Flange Gasket, PTFE, Ø55x12.5mm, for "WEV-1010", "WEV-1020" |
| 18 | SL.Ev1010.A18 | Under Stand Pole, SUS304, Ø25x704mm, for "WEV-1010", "WEV-1020" | | | |

witeg® 50 Lit. Digital Rotary Evaporator, "WEV-1050" Large Capacity, Vertical Type, with Electric & Manual Lift Bath
Digital Controlled Stainless Steel Bath 99°C, 10~110 rpm, 19 Lit/h, Cooling Surface 14.500cm² with Certificate & Traceability

- Cooling Surface 14.500cm²
- Large Capacity & Diameter Rotary Evaporator Flask - 50Lit.
- PTFE and Fluorine Rubber Dual Rotating Seal, Patented Technology to Ensure High Vacuum.
- Stainless Steel Water Bath - Electric & Manual Lift, Easy to Use
- * Ideal for Distill of (Mixed) Solvent, Condensation Solution and Suspension, Concentrate Liquid, Re-crystallization, Dry Powder and Granulate, Synthesize Chemical, Soxhlet Extraction, Recycle Solve
- * The Introduction of Advanced Frequency Control System, Temperature Control System, Accurate and Reliable.
- * A Vacuum Switching Valve, without Affecting the System Vacuum Distillation of the Situation and the Solution can be Continuously Collected.
- * Water Bath Electric Lift and Manual Lift Support, Easy to Use.
- * PTEE Discharge Valve, Corrosion Resistance, Pollution-free.
- * This Rotary Evaporator could Set with Circulation Aspirator Pump(P.51) and Refrigerated Bath Circulator(P.30 ~ P.31).

NEW

Wisd
2-Year Warranty



Digital Rotary Evaporator, Large Capa.
"WEV-1050", 50 Lit.

| Spec. / Model | WEV-1050 |
|-----------------------------|---|
| Rotary Bottle | 50 Lit., Flange Opening Ø125mm |
| Receiving Bottle | 20 Lit. |
| Condenser | Standing, Main & Auxiliary Cooling and Highly Efficient 3 Circulating Cold Trap |
| Temp. Range | 0°C - 99°C |
| Rotary Speed | 10 - 110rpm |
| Evaporating Capability | Water: 9Lit./h Alcohol: 19Lit./h |
| Cooling Surface | Main Condenser: 9.500cm² Auxilliary Condenser: 5.000cm² |
| Achievable Vacuum | 399.9Pa (below 3mmHg) |
| Functional of Lifting Table | Electric |
| Elevating Stroke | 0 - 230mm |
| Vacuum Sealing | PTFE and Fluorine Rubber Dual Rotating Seal |
| Motor | Phase AD Induction Motor 90 W |
| Heating Boiler | Stainless Steel Water Bath |
| Display | Digital Display |
| Power Consumption | 8.3 kW |
| Dimension (mm) | 1320 x 770 x h2340 |
| Power Supply & Cord Plug | 380V, 50Hz |

Ordering Information

DH.WEV01050 Digital Rotary Evaporator, Large Capa., 50Lit., "WEV-1050", 380V

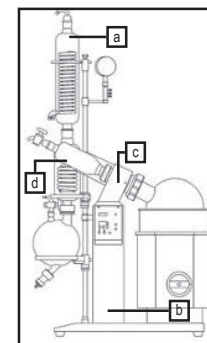
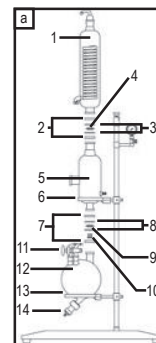

| No. | Order Number | Description | No. | Order Number | Description |
|-----|---------------|--|-----|---------------|--|
| 1 | SL.Ev1050.A01 | Glass Condenser(Main), Ø165x575mm | 21 | SL.Ev1050.A21 | Vacuum Gauge Holder, Copper, Ø25xØ12mm |
| 2 | SL.Ev1050.A02 | Connection Flange Set, Aluminum, Ø110x15mm | 22 | SL.Ev1050.A22 | Machine Head Capsule, Aluminum, 300x100x230mm |
| 3 | SL.Ev1050.A03 | Flange Retaining Ring, EPDM, Ø86.5x10mm | 23 | SL.Ev1050.A23 | Water Bath, SUS304 |
| 4 | SL.Ev1050.A04 | Flange Gasket, PTFE, Ø75x12.5mm | 24 | SL.Ev1050.A24 | 3-way Glass Bottles, Ø100x358mm |
| 5 | SL.Ev1050.A05 | Auxiliary Glass Condenser, Ø165x575mm | 25 | SL.Ev1050.A25 | Fixed Nut, for 3-way Glass Bottles, Aluminum, Ø105x31mm |
| 6 | SL.Ev1050.A06 | Auxiliary Glass Condenser Tray, EPDM, Ø167mm | 26 | SL.Ev1050.A26 | Fixed Nut Retainer Ring, 3-way Glass Bottles, PA, Ø90x11mm |
| 7 | SL.Ev1050.A02 | Connection Flange Set, Aluminum, Ø110x15mm | 27 | SL.Ev1050.A27 | Flange Seals, PTFE, Ø65x12.5mm |
| 8 | SL.Ev1050.A03 | Flange Retaining Ring, EPDM, Ø86.5x10mm | 28 | SL.Ev1050.A28 | Rotation Glass Axis, Ø69x210mm |
| 9 | SL.Ev1050.A04 | Flange Gasket, PTFE, Ø75x12.5mm | 29 | SL.Ev1050.A29 | O-ring, EPDM, Ø55x3mm |
| 10 | SL.Ev1050.A10 | Automatic Switching Valve, Ø40x24mm | 30 | SL.Ev1050.A30 | Couplings, SUS304, Ø144x42mm |
| 11 | SL.Ev1050.A11 | Glass Bleed Valve | 31 | SL.Ev1050.A31 | Main Vacuum Seal, PTFE, Ø125x10mm |
| 12 | SL.Ev1050.A12 | Glass Receiving Bottle, 2Lit. | 32 | SL.Ev1050.A32 | Deputy Vacuum Seal, PTFE, Ø125x10mm |
| 13 | SL.Ev1050.A13 | Glass Receiving Bottle Tray, Ø332mm | 33 | SL.Ev1050.A33 | Retaining Ring, PA, Ø134x16mm |
| 14 | SL.Ev1050.A14 | Discharge Valve, PTFE, Ø68x100mm | 34 | SL.Ev1050.A34 | Rotating Shaft Nut, PA, Ø175x45mm |
| 15 | SL.Ev1050.A15 | Condenser Clamp, SUS304, 150-220 | 35 | SL.Ev1050.A35 | Glass Revolving Bottle, 50Lit. |
| 16 | SL.Ev1050.A16 | Stand Pole, SUS304, Ø25x1017mm | 36 | SL.Ev1050.A36 | Glass Feeding Valve |
| 17 | SL.Ev1050.A17 | Stand Folder, SUS304, Ø25x12mm | 37 | SL.Ev1010.A32 | Connection Flange Set, Ø90x12mm |
| 18 | SL.Ev1050.A18 | Under Stand Pole, SUS304, Ø25x1024mm | 38 | SL.Ev1010.A33 | Flange Retaining Ring, EPDM, Ø70x10mm |
| 19 | SL.Ev1050.A19 | Stand Base, Carbon Steel, 1022x486mm | 39 | SL.Ev1010.A34 | Flange Gasket, PTFE, Ø55x12.5mm |
| 20 | SL.Ev1010.A20 | Vacuum Gauge, Ø100mm | | | |

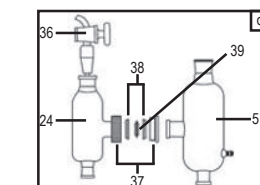
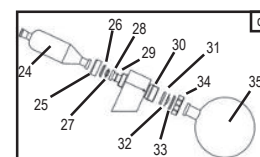
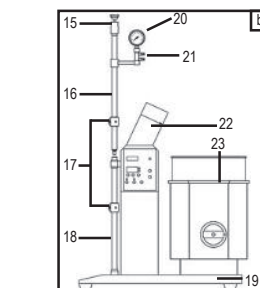

<Continued from... 50 Lit. Digital Rotary Evaporator, "WEV-1050">

witeg® Digital Rotary Evaporator Full System



The Wisd Digital Rotary Evaporator could set with Circulation Aspirator Pump and Refrigerated Bath Circulator. This system gives you unlimited possibilities in distillations, evaporations, separations, concentrations and purifications. The witeg could gives you more comfortable selection guides for Evaporation.

Evaporator Full System : Digital Rotary Evaporator + Circulation Aspirator Pump + Refrigerated Bath Circulator
Each Items Details See Page P. 30~P. 31, P. 51

witeg® Electric Circulation Aspirator Pump, "WEV-003S" 15 Lit. PP Water Tank, Safety Check Valve
80 Lit./min, 0.098 MPa



Electric Circulation Aspirator Pump "WEV-003S"
15 Lit., 0.098MPa, 80Lit./min

- witeg® Designed China-made
 - Cyclically use Water, Save the Precious Water Resources.
 - Save more than 35% of Electricity than other type of Vacuum Pump.
 - Double-tap, Double-display, can be used alone or in Parallel.
 - Resist Corrosion by Acid, Alkali and Solvents.
- * The Fluid Muffler Purposemade can Reduce the Gas in Water and make the Vacuum Degree Higher and more Stable Reduce the Friction between Gas and Fluid, Reduce the Noise.
 * luorine Rubber Sealing, the inner of which can t be Intruded by Corrosive Gas.
 * Need to Replace the Water in the Flume Regularly to ensure the Purity of Water Quality, the Vacuum Degree and to Avoid Dirt Stains.
 * -Can be used to Extract Corrosive Gas, need to Shorten the Period of Water Changing.

Specification

| Spec. | Model | "WEV-003S" |
|-------------------------------|-------|-----------------------------|
| Capacity(Water Tank) | | 15 Lit. |
| Max. Vacuum Degree | | 0.098 MPa |
| Flow | | 80 Lit./min |
| Lift | | 10 m |
| Single Tap Air Sucking Amount | | 10 Lit./min, 2A |
| Safety Function | | Check Valve |
| Material of Water Tank | | PP |
| Dimension & Net Weight | | 385 x 280 x h420 mm / 11 kg |
| Power Consumption | | 180 W |
| Power Supply | | 220V, 50Hz |

Ordering Information

DH.WEV0003S Circulation Aspirator Pump, 15Lit., "WEV-003S", 220V

Rotary Vacuum Evaporator

Home of Innovations

NEW

Distillation

Rotary Evaporator
GREASELESS
digital rpm display
20-280rpm
CE-certified



GREASELESS

...no drops of grease / oil anymore in the media resulting from the joints!



Rotary Vacuum Evaporator Greaseless

greaseless connection / joints

Based on the accumulated technologies for the last 50 years, we have strived for quality improvement and development of scientific research equipment. Finally, Rotary Evaporator „greaseless“ is the answer to our efforts. Witeg will work harder to make the best product for our customers around the world.

The experts in this business are asking for years for a solution in the evaporating / distillation operation to avoid drops of grease in the media. We are now having the answer with the new *witeg HAHNVAPOR* *greaseless*.



NEW

Digital Bath Circulator *WiseCircu WCR*

witeg HAHNVAPOR Rotary Vacuum Evaporator

▪ Advantages

- Easy and accurate height control by using a simple up/down button.
- Our special vacuum seal is made of double-binding PTFE and NBR nitrile in order to provide the seal with anti-abrasion, anti-aging and anti-chemical functionality, which enables the machine to make higher vacuum pressure compared to most of other imported equipment.
- The leaning angle of the evaporating flask can be easily manipulated by screwing a simple bolt type controller.
- Combi-Clip can easily remove or attach the evaporating flask.
- The insulated heater prevents the machine from burning accident and heat loss.
- Water bath is made of stainless steel to prevent it from undesirable corrosion of the bath.
- Special glassware for greaseless usage.

▪ Condition of Evaporating Capacity

- Temperature of cooling water: 25°C – 27°C
- Sample Flask: 1l
- Sample Input: 500ml
- Vacuum pressure: 760mmHg

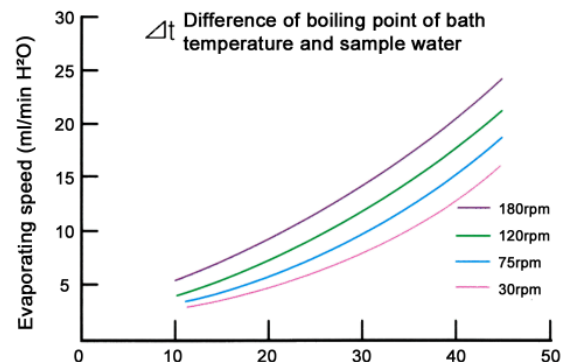

▪ Conditions for distillation

- Set water temperature in water bath at 60°C.
 - Set the cooling water speed at 40-60 l/h.
 - Inject the cooling water (15 - 25°C) into the condenser coil.
 - Set the vacuum degree at 700mmHg or above.
-
- 6 types of flasks ranging from 50ml to 3000ml.
 - Rotary Evaporator is equipped with speed control and rpm value is displayed in digital.
 - Digital water bath covers ambient temperature up to 180°C.
 - If water level at heating bath goes down, power will be cut off automatically by sensor.
 - Speed control 20-280 rpm.

Rotary Vacuum Evaporator Greaseless greaseless connection / joints

witeg *HAHNVAPOR* Rotary Evaporator diagonal



Order No.: 2 600 000

NEW

CE-certified

Dimensions(W*D*H) : 730*410*630mm
Power source : AC 230V 50/60Hz 2.5A
Weight: 19.5kg
Distinguished Features
6 different types of flasks are attachable (from 50ml to 3000ml)
Digital speed control
Digital rpm Display
Speed control range : 20~280 rpm
Diagonal type condenser
Digital interior temperature measure and display
(It catches the temperature changes caused by the interior pressure drops)
Motorized UP-DOWN control switch
Easy to utilize standard distillation solution

Included Water bath
Heater : 1000W / Bath Material : SUS304 / Weight : 2.8kg
Bath Dimensions(Ø * H)mm : 245*120 (Capacity:4.3ℓ)
Required Power Source : AC 230V 60Hz 4.5A

Distinguished Features
If the amount of water goes down under the certain threshold in the heating bath, the system automatically turns off its power for the safety purpose.
Temp.Control range : Amb.~180°C
Temp.Setting/Display : Digital control (controlled by the main controller)
Double jacketed bath body (Safe to touch)

Operating panel

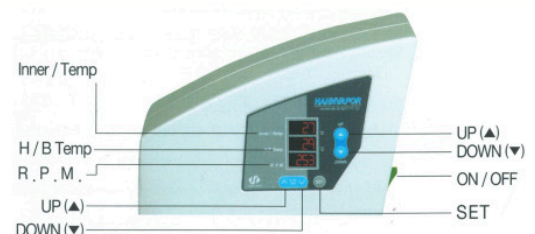

witeg HAHNVAPOR Rotary Evaporator vertical

Order No.: 2 610 000



NEW

CE-certified

Dimensions(W*D*H) : 620*410*870mm

Power source : AC 230V 50/60Hz 2.5A

Weight : 19.5kg

Distinguished Features

6 different types of flasks are attachable (from 50ml to 3000ml)

Digital speed control

Digital rpm Display

Speed control range : 20~280 rpm

Vertical type condenser

Digital interior temperature measure and display

(It catches the temperature changes caused by the interior pressure drops)

Motorized UP-DOWN control switch

Easy to utilize standard distillation solution

Included Water bath

Heater : 1000W / Bath Material : SUS304 / Weight : 2.8kg

Bath Dimensions(Ø * H)mm : 245*120 (Capacity:4.3ℓ)

Required Power Source : AC 230V 60Hz 4.5A

Distinguished Features

If the amount of water goes down under the certain threshold in the heating bath, the system automatically turns off its power for the safety purpose.

Temp.Control range : Amb.~180°C

Temp.Setting/Display : Digital control (controlled by the main controller)

Double jacketed bath body (Safe to touch)



Order No.: DH.WCT00140

Digital Precise Cold Trap *WiseCircu WCT*

▪ SPECIFICATION

- Capacity: 10l
- Bath Dimension (WxDxH): 220 x 220 x 210mm
- Type: Glass Trap
- Temp. Range: 0°C to -40°C
- Controller: Digital Fuzzy Controller
- Refrigerator: 368W
- Refrigerant: 404A
- Dimension (WxDxH): 377 x 453 x 705mm
- Packaging Dimension (WxDxH): 560 x 500 x 1010mm
- Gross weight: 67kg
- Power Consumption: 900W
- Power Supply: AC 230V, 50/60Hz

▪ APPLICATION & FEATURES

- Ideal for Exceptional Cooling System like Collecting Evaporation Vapor Hazardous Vapor from Vacuum Line.
- Digital PID Controller.
- Durable Stainless Steel Bath and Powder Coated Steel.
- Over Current Protection, Sensor Error Detection, Leakage Breaking.
- CFC-free (404A) Refrigeration System.
- Patented Jog-Shuttle Control System and Digital LCD Display with Back-Light Function.
- CE Certified.

Wisd Fuzzy Control System

Digital Intelligence, Maximum Efficiency

Multi-Functional Digital Feedback Controller
incorporated into all witeg Digital Instruments



► Digital LCD Display

- High-Quality LCD with Back-Light Function
- Displays Set Value, Present Value and Operation Status

► Intuitive Operation Lamps

- Indicates Operation Status of the Machine Heating, Stirring, Timer, Refrigeration, etc.

► Jog-Shuttle (Turn + Push)

- Unified Controlling Knob for All Operation of the Unit
- Input of Set Value, Start & Stop of Operation, Storage of Set Values



Order No.: DH.WCR00206

Digital Bath Circulator *WiseCircu WCR*

■ SPECIFICATION

- Capacity: 6l
- Bath Dimension (WxDxH): 180 x 250 x 150mm
- Circulation Pump: Max flow 15l/min
- Temp. Range: -20°C to 100°C
- Controller: Digital Fuzzy Controller
- Refrigerator: 245W
- Refrigerant: 404A
- Dimension (WxDxH): 262 x 468 x 630mm
- Packaging Dimension (WxDxH): 530 x 370 x 700mm
- Gross weight: 50kg
- Power Consumption: 1,4kW
- Power Supply: AC 230V, 50/60Hz

■ APPLICATION & FEATURES

- Ideal for Direct Immersion of Samples or External Circulating System in the field of Biotechnology and Laboratories.
- Innovative Easy-to-Use Digital Fuzzy Controller.
- RS232C Interface for Remote Monitoring and Controlling with PC.
- Digital Timer Function: 'Delay Time' and 'Operation Time' can be Controlled.
- Stainless Steel Bath(#304) for Superior Durability & High Thermal Efficiency.
- Powerful Circulation Pump ensures Temp. Uniformity: Internal and External Circulation.
- Connection with Evaporator or Viscometer is applicable.
- User's Self-compensation Function to Control Difference between Real Temperature and Indicated Temperature. ($\pm 10,0^{\circ}\text{C}$)
- Warning and Auto-Stop Function in case of Liquid Shortage.
- Auto-controlled Refrigeration System for Compressor Protection and Power Saving.
- Over Temperature & Over Current Protection, Sensor Error & Low Level Detection, Leakage Breaking.
- CFC-free (404A) Refrigeration System.
- Patented Jog-Shuttle Control System and Digital LCD Display with Back-Light Function.
- CE Certified.

● Digital Fuzzy Control System

- Digital Feedback control by High-Performance Microprocessor
- Superior control accuracy for Temperature & RPM

● Easy-to-Use

- Compact Design and Simplest User-Interface
- 1 or 2 Mode Buttons + Jog-Shuttle Switch

● Patented User-Interface

- Specially Designed Operation Mode Mechanism for Intuitive Setting & Control
- Simple Mode Transition (eg. Set Temp Mode → Set RPM Mode → Set Timer Mode → Locking Mode)

Equipment

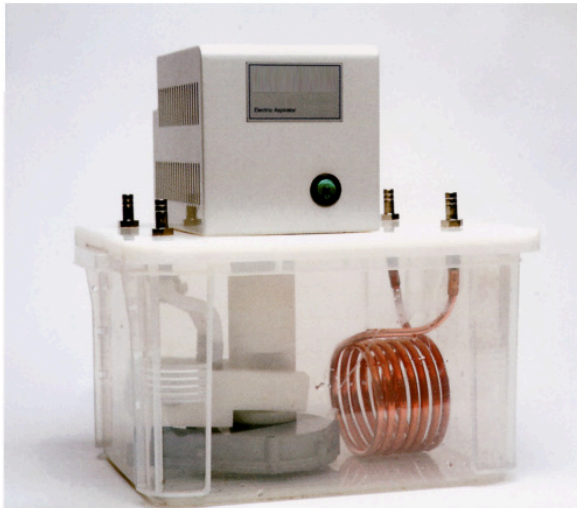

Option



Vacuum Gauge



Cooling Coil (Copper)

Order No.: 2 600 031

Electric Aspirator

▪ SPECIFICATION

- Pump Capacity: 18l/min x 2EA
- Bath Capacity: 8l
- Motor Power: 150W
- Material of Bath: Polypropylene
- Material of Aspirator: Metal 2 pcs
- Safety: Fuse
- Power source: AC 230V 50/60Hz 0.7A
- Dimensions (WxDxH): 320 x 240 x 330mm
- Weight: 6kg

▪ FEATURE

- Excessive consumption of water may be reduced that can happen when city piped water is used.
- Utilizing water pressure gained by motor pump, two aspirators can be installed.
- By preventing reflux of air, vacuum, filtering and vacuum distillation are possible.
- Applicable to Rotary vacuum Evaporator.
- A cooling coil could be installed to prevent the loss of vacuum effect in the case when the water temperature increases (option).
- Vacuum controller could be equipped for checking degree of vacuum status during the operation.
- Bath is made of Polypropylene which is strong and lasts long.
- CE-certified



Order No.: 2 600 032

Vacuum Controller

▪ SPECIFICATION

- Solid state module maintains precise control (+/- 3%) of the system vacuum by cycling the pump on/off as required.
- Adjustable for any level between 1mmHg and 760mmHg.
- Power Source: AC 230V 50/60Hz
- Dimensions (WxDxH): 160 x 130 x 95mm
- Weight: 1,8kg
- CE-certified



Order No.: 2 600 033

Vacuum Pump

▪ SPECIFICATION

- Pump Speed: 100l/min
- Ultimate Pressure Torr(Pa): 5×10^{-4} (6,7 x 10⁻²)
- Full Load Power: 0,4kw
- Motor Speed: 1700rpm
- Oil Capacity: 500ml
- Ambient Operation Temp. Range: 7°C - 40°C
- Overall Dimensions (WxDxH): 150 x 392 x 250mm
- Power Source: AC 230V 50/60Hz 2A
- Weight: 19kg
- CE-certified



Order No.: 2 600 034

Diaphragm Vacuum Pump

▪ Diaphragm Pumps for Air, Gases and Vapors

▪ SPECIFICATION

- Delivery (l/min): 20
- Ultimate vacuum (mbar abs): 7
- Operating pressure (bar g): 1
- Connectors for tube (mm): OD 10
- Permissible gas and ambient temperature: +5°C...+40°C
- Voltage / Frequencies: 230V 50Hz - 60Hz
- Power P₁: 180W
- Operating current: 1,2A
- Weight: 9,3kg
- Dimensions (WxDxH): 270 x 180 x 220mm

▪ TECHNICAL FEATURES

- 100% oil-free transfer
- Pure transfer, evacuation and compression
- Highly compatible with vapors and condensation
- Chemically-resistant
- Therefore suitable for highly aggressive and corrosive gases and vapors
- Maintenance-free
- Environmentally friendly
- CE-certified

Glass Assembly „Preciso“ greaseless

2 600 000

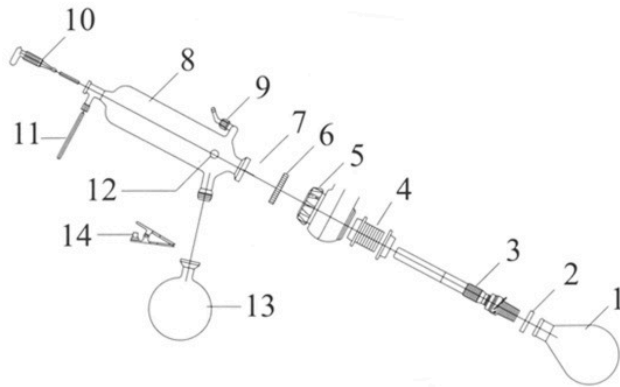

| | | |
|----|--------------------------|-----------------------|
| 1 | Evaporating Flask | 0 654 001 FCH-V |
| 2 | Joint Clamp | 0 131 329 0 131 629 |
| 3 | HAHNVAPOR Duct | 2 600 0072 |
| 4 | Duct Screw Cap | 2 600 040 |
| 5 | Condenser Screw Coupling | 2 600 041 |
| 6 | Condenser Holder Spring | 2 600 042 |
| 7 | Vacuum Seal | 2 600 018 |
| 8 | Assembly Condenser | 2 600 009 |
| 9 | Vacuum Connector | 2 600 044 |
| 10 | Vacuum Stop-cock | 2 600 010 |
| 11 | Drawing Teflon Hose | 2 660 019 |
| 12 | Vapor Sensor | 2 660 020 |
| 13 | Receiving Flask | 0 644 500 ROT |
| 14 | Receiving Flask Clamp | 0 133 035 |

2 610 000

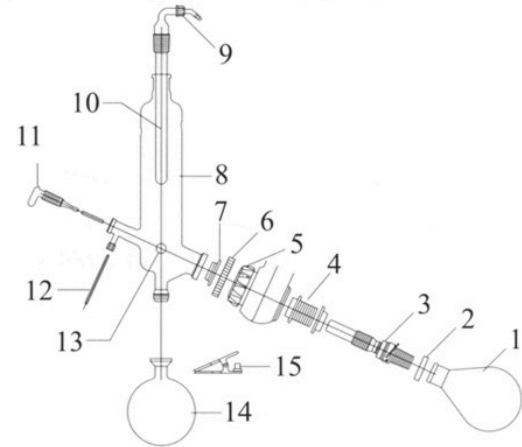

| | | |
|----|--------------------------|-----------------------|
| 1 | Evaporating Flask | 0 654 001 FCH-V |
| 2 | Joint Clamp | 0 131 329 0 131 629 |
| 3 | HAHNVAPOR Duct | 2 600 0072 |
| 4 | Duct Screw Cap | 2 600 040 |
| 5 | Condenser Screw Coupling | 2 600 041 |
| 6 | Condenser Holder Spring | 2 600 042 |
| 7 | Vacuum Seal | 2 600 018 |
| 8 | Assembly Condenser | 2 600 006 |
| 9 | Vacuum Connector | 2 600 045 |
| 10 | Vacuum Adapter | 2 600 044 |
| 11 | Vacuum Stop-cock | 2 600 010 |
| 12 | Drawing Teflon Hose | 2 600 019 |
| 13 | Vapor Sensor | 2 600 020 |
| 14 | Receiving Flask | 0 644 300 |
| 15 | Receiving Flask Clamp | 0 133 035 |

Glass Assembly



Joint Clamp
0 131 329



Joint Clamp
0 131 629



Condenser-A
2 600 009



Condenser-B
2 610 006



Vacuum Seal
2 600 018



Receiving Flask
Ball Clamp
0 133 035

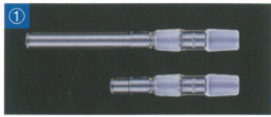

- ① HAHNVAPOR duct: ST 24/29, PTFE, l=312mm 2 600 0071 TEF
 ST 24/29, PTFE, l=200mm 2 600 0072 TEF
 ST 24/29, glass, l=312mm 2 600 0071
 ST 24/29, glass, l=200mm 2 600 0072

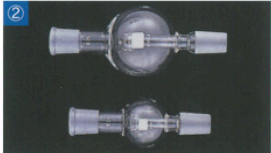

- ② Bulbs for flask ST 24/29: l=100mm 1 430 224
 l=250mm 1 430 230
 Bulbs for flask ST 29/32: l=100mm 1 430 190
 l=250mm 1 430 200

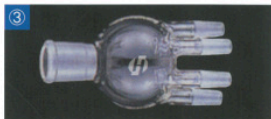

- ③ Four neckbulbs for flask: ST 24/29 socket 1 430 400
 ST 14/23 cone



- ④ Stop-cock ST 19/38, glass, with PTFE-tubing:
 NEW PTFE version 4/1 2 600 010
 4/2 2 600 010 TEF

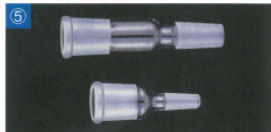

- ⑤ Connecting Adapters: ST 24/29 socket 0 510 002
 ST 14/23 cone
 ST 24/29 socket 0 510 006
 ST 29/32 cone



- ⑥ Evaporating flask greaseless:
- | Capacity: | ST 24/29 | | ST 29/32 | | standard: | |
|-----------|-----------|-------|-----------|-------|-----------|-----------|
| | | | | | ST 24/29 | ST 29/32 |
| 50ml | 0 654 050 | FCH-V | 0 655 050 | FCH-V | 0 654 050 | 0 655 050 |
| 100ml | 0 654 100 | FCH-V | 0 655 100 | FCH-V | 0 654 100 | 0 655 100 |
| 250ml | 0 654 250 | FCH-V | 0 655 250 | FCH-V | 0 654 250 | 0 655 250 |
| 500ml | 0 654 500 | FCH-V | 0 655 500 | FCH-V | 0 654 500 | 0 655 500 |
| 1l | 0 654 001 | FCH-V | 0 655 001 | FCH-V | 0 654 001 | 0 655 001 |
| 2l | 0 654 002 | FCH-V | 0 655 002 | FCH-V | 0 654 002 | 0 655 002 |
| 3l | 0 654 003 | FCH-V | 0 655 003 | FCH-V | 0 654 003 | 0 655 003 |

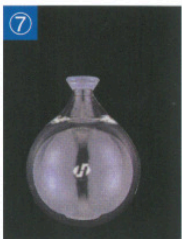

- ⑦ Receiving flask greaseless:
- | Capacity: | S 35/20 | | standard: | |
|-----------|-----------|-----|-----------|--|
| | | | S 35/20 | |
| 100ml | 0 644 100 | ROT | 0 644 100 | |
| 250ml | 0 644 250 | ROT | 0 644 250 | |
| 500ml | 0 644 500 | ROT | 0 644 500 | |
| 1l | 0 644 001 | ROT | 0 644 001 | |
| 2l | 0 644 002 | ROT | 0 644 002 | |
| 3l | 0 644 003 | ROT | 0 644 003 | |

Rotary Vacuum Evaporator

GREASELESS

...no drops of grease / oil anymore in the media resulting from the joints!

